

NOTES:

DESIGN INTENT DRAWING

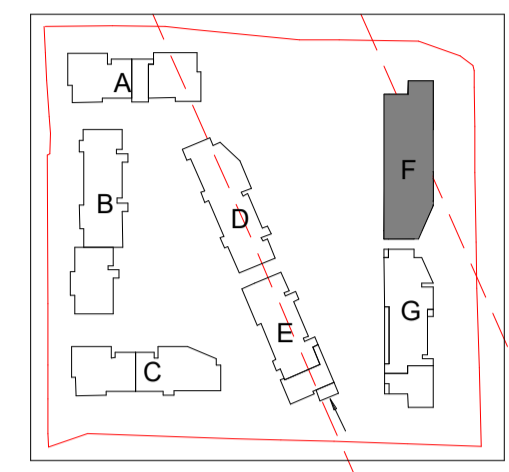

Room Legend

- EH/C Entrance Hall / Corridor
- KLD Kitchen / Living / Dining Room
- BD1 Bedroom 1
- BD2 Bedroom 2
- BD3 Bedroom 3
- BR Bathroom
- BR/ES Bathroom / En Suite
- ES En Suite
- ST Store
- POS Private Open Space
- ER Electrical Riser
- MR Mechanical Riser
- MSV Mechanical Smoke Vent



1 GA - Fifth Floor Plan
1 : 100

Rev	Description	Date	Dr by	App by

PLANNING

Client:
Eastwise Construction Swords Limited

Project:
Hartfield Place
Swords Road, Whitehall, Dublin 9
D09 C7F8

Drawing Title:
BLOCK F - Fifth Floor GA - 472 Units

Drawn	Checked	Paper Size	Scale	Date
DP	CM	A1	1 : 100 @A1	Mar. 2022

Project No.	Drawing No.	Classification	Revision
HARTPL	062505		

File Name:
HARTPL-CWO-BF-05-DR-A-062505

Status:
S2-Suitable For Information



No.1 Sarsfield Quay, Dublin 7, D07 R9FH
t: 01 518 0170 e: admin@cwoarchitects.ie
Dublin | Cork | Galway | London | UK & Europe +
www.cwoarchitects.ie

Please consider the environment before printing this sheet